

- **TRIM—IGNITION LOCK CYLINDER DIFFICULT TO TURN, UNABLE TO REMOVE KEY OR STICKING IGNITION KEY—IGNITION LOCK CYLINDER REMOVAL PROCEDURE**
- **STARTING—IGNITION LOCK CYLINDER DIFFICULT TO TURN, UNABLE TO REMOVE KEY OR STICKING IGNITION KEY—IGNITION LOCK CYLINDER REMOVAL PROCEDURE**

**Article No.  
02-18-2**

**FORD:** 2000-2002 FOCUS

**ISSUE**

Some vehicles may exhibit a difficult to turn, unable to insert, or sticking Ignition Key. This may be caused by the Ignition Lock Cylinder (ILC).

**ACTION**

An Ignition Lock Cylinder Kit (XS4Z-11582-AA), and a Stuck Ignition Lock Cylinder Removal Procedure have been developed to service this condition. Refer to the following Service Procedure to remove the sticking lock cylinder, then use the Lock Cylinder Kit to service.

**SERVICE PROCEDURE**

If the Ignition Key is unable to be inserted or rotated, then follow the below procedure. If the Ignition Key is only difficult to turn then use the Service Kit only.

1. Remove steering wheel, as per Workshop Manual Section 211-04 procedures.
2. Remove the PATS Transceiver, as per Workshop Manual Section 419-01B procedures.
3. Draw a line through the middle of the ILC face 90 degrees to the key slot (Figures 1 and 2).
4. Mark a point on that line 3mm down from the slot. This point will be just beyond the center of the lock face (Figure 3).
5. Drill a 4mm pilot hole 3mm deep. Then drill a 10mm hole 35mm deep (mark 35mm on drill bit) (Figures 4, 5, 6, and 7).

6. Remove lockbar from side of the hole. Rotate ILC while depressing retainer pin on the housing and pull out (Figures 8, 9, and 10).
7. Use Lock Cylinder Repair Kit (XS4Z-11582-AA) to repair and reassemble as per Workshop Manual Section 501-14A procedures.
8. Install PATS Transceiver as per Workshop Manual Section 419-01B procedures.
9. Install Steering Wheel as per Workshop Manual Section 211-04 procedures.
10. Remove any debris created by drilling the lock cylinder.
11. Verify repair.

PART NUMBER	PART NAME
XS4Z-11582-AA	Ignition Lock Cylinder Kit

**OTHER APPLICABLE ARTICLES:** NONE

**WARRANTY STATUS:** Eligible Under The Provisions Of Bumper To Bumper Warranty Coverage

OPERATION	DESCRIPTION	TIME
021802A	Replace Ignition Lock Cylinder (Includes Time To Drill And Remove Existing Lock Cylinder Then Assemble New Lock Cylinder And Install)	1.1 Hrs.

# Article No. 02-18-2 Cont'd.

## DEALER CODING

BASIC PART NO.

11582

OASIS CODES: 112000, 190000

CONDITION

CODE

41

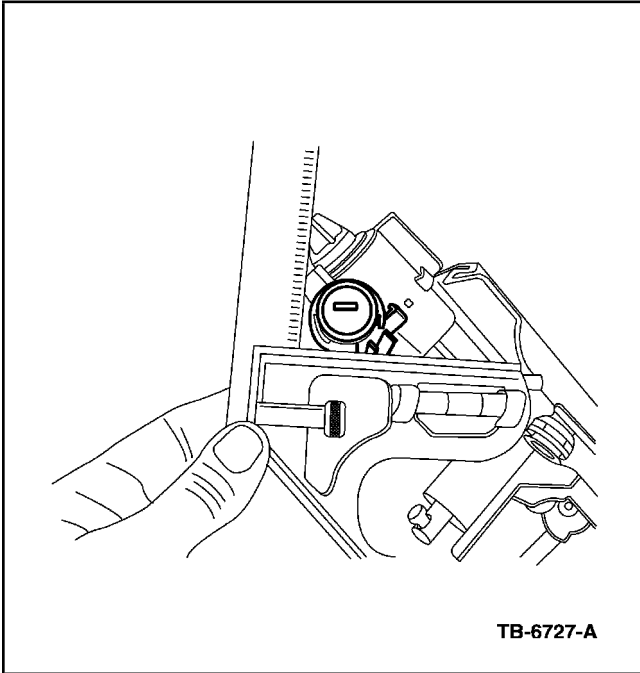

Figure 1 - Article 02-18-2

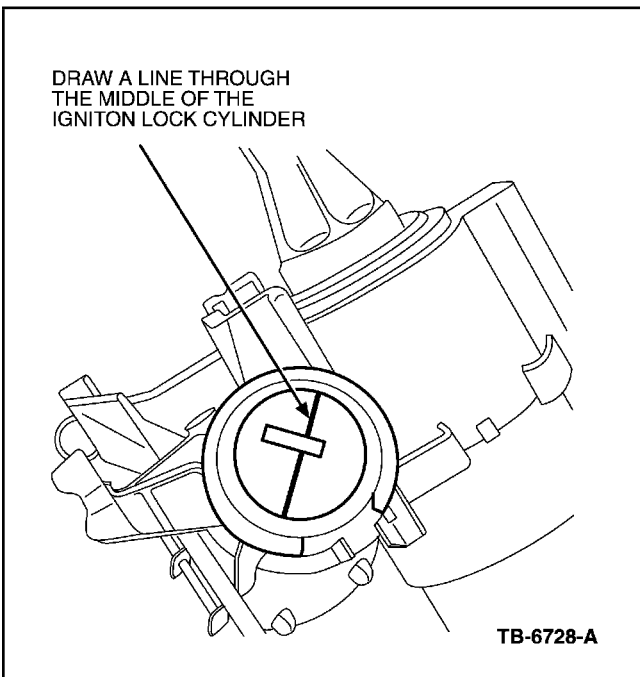

Figure 2 - Article 02-18-2

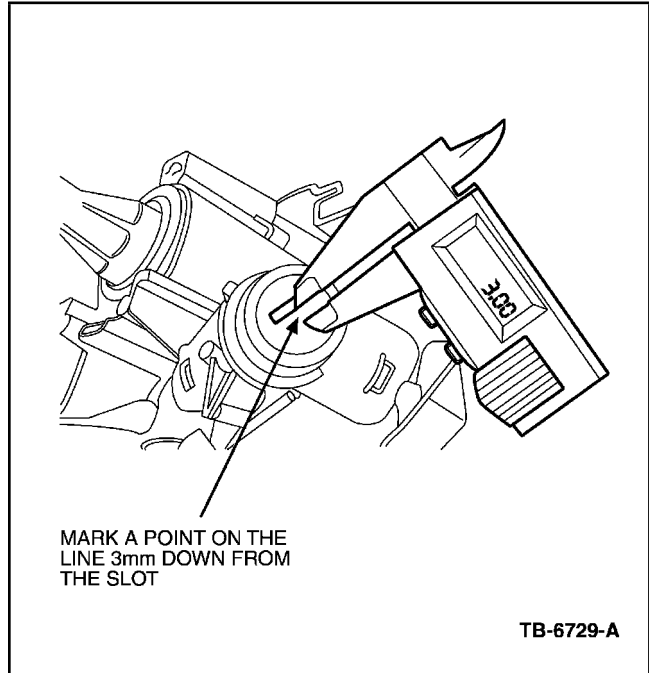

Figure 3 - Article 02-18-2

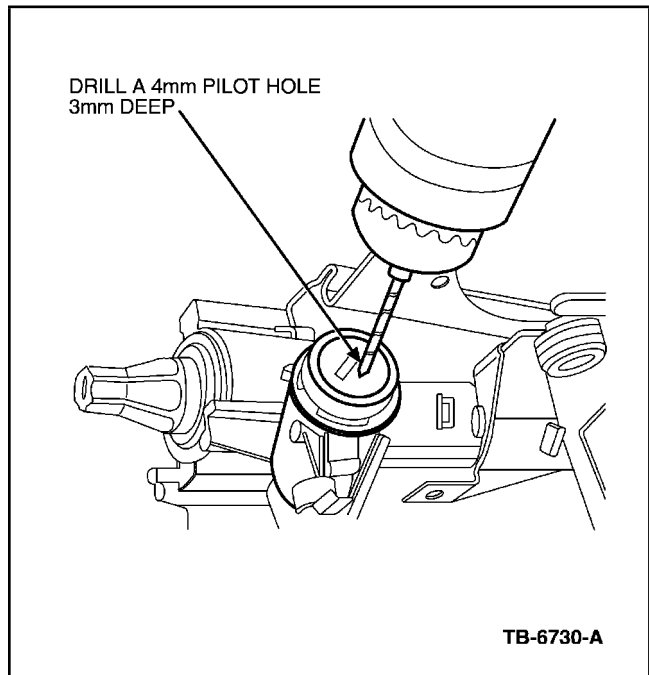

Figure 4 - Article 02-18-2

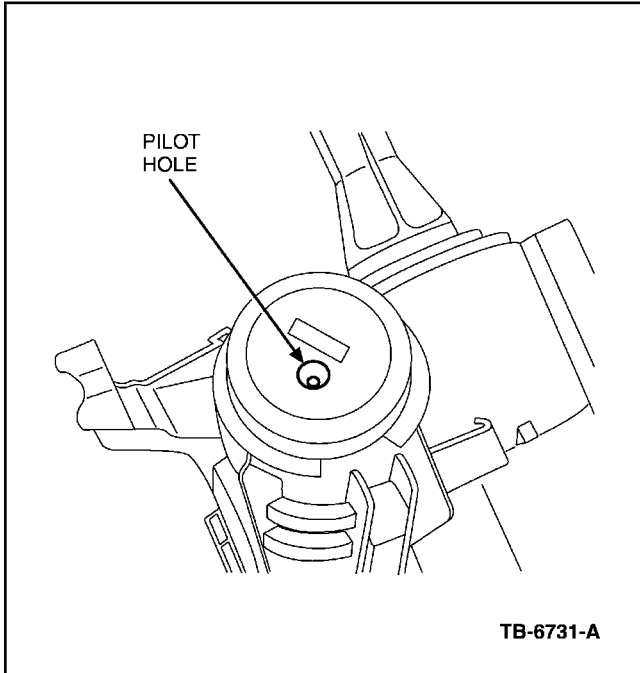

Figure 5 - Article 02-18-2

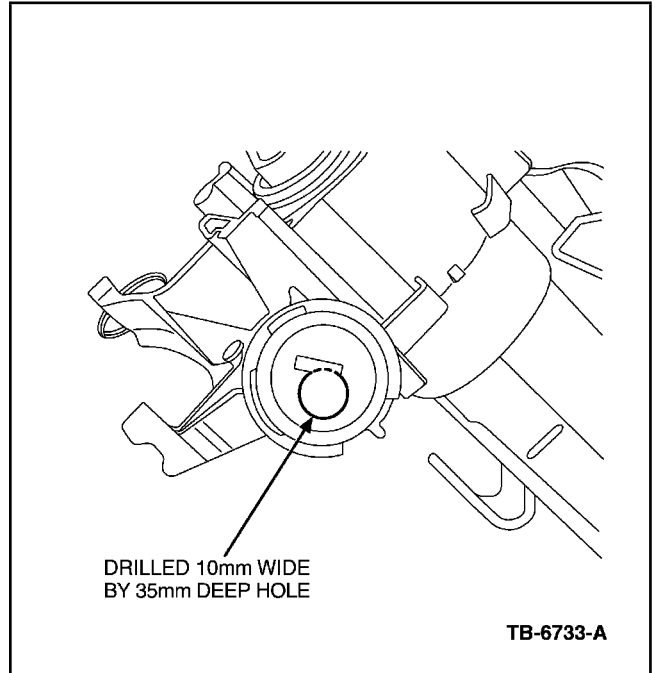

Figure 7 - Article 02-18-2

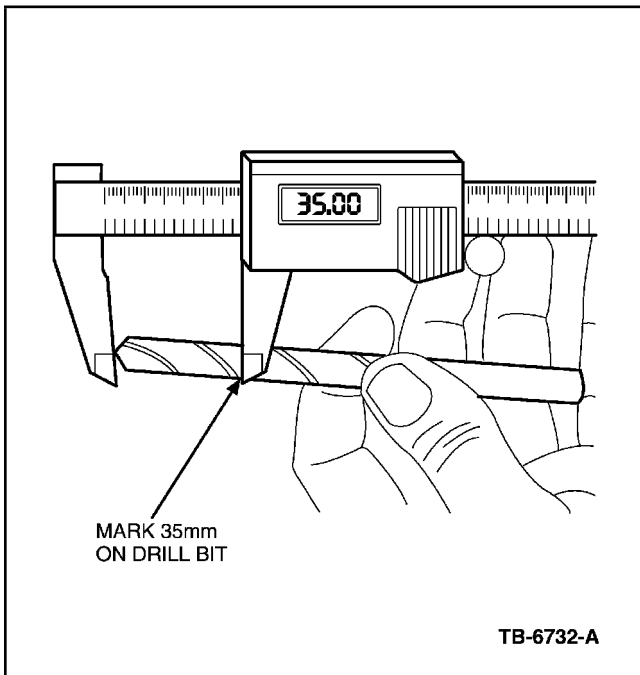

Figure 6 - Article 02-18-2

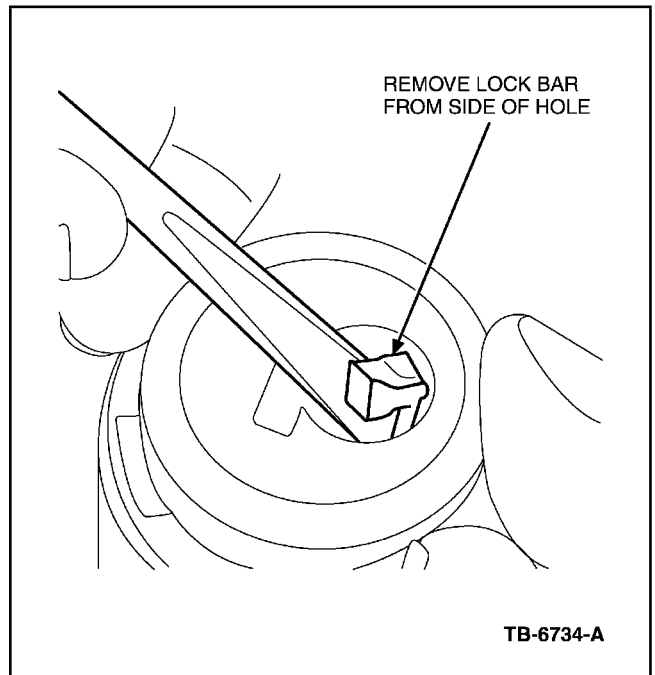

Figure 8 - Article 02-18-2

## Article No. 02-18-2 Cont'd.

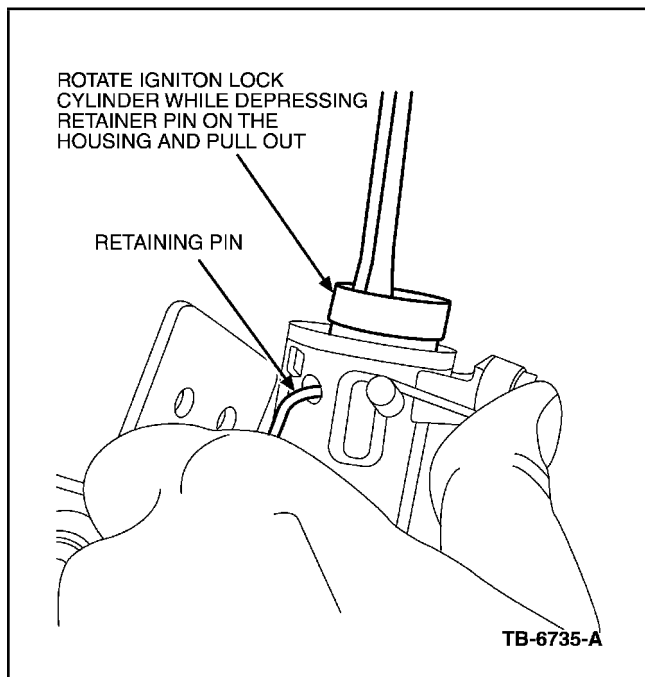

Figure 9 - Article 02-18-2

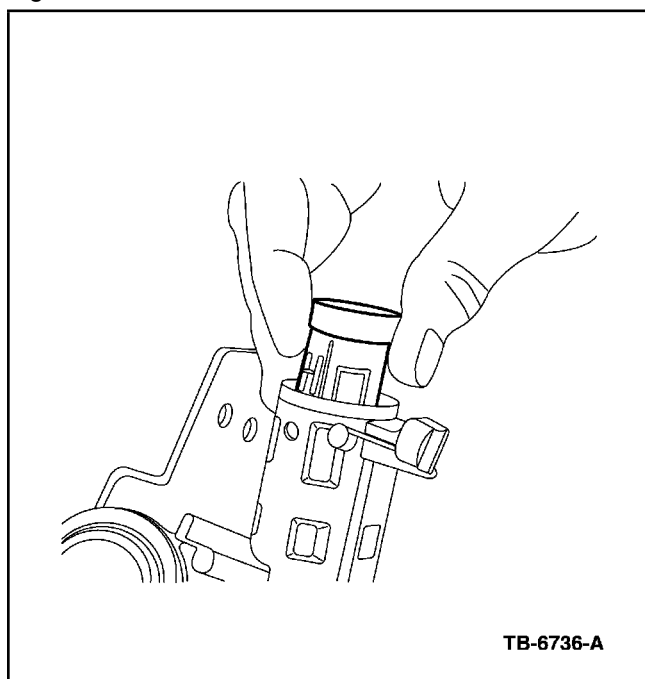

Figure 10 - Article 02-18-2

**NOTE:**The information in Technical Service Bulletins is intended for use by trained, professional technicians with the knowledge, tools, and equipment to do the job properly and safely. It informs these technicians of conditions that may occur on some vehicles, or provides information that could assist in proper vehicle service. The procedures should not be performed by "do-it-yourselfers". Do not assume that a condition described affects your car or truck. Contact a Ford, Lincoln, or Mercury dealership to determine whether the Bulletin applies to your vehicle.